



RULES

National Ploughing Association

2015/2016





'15/16

TIME SIGNALS

NATIONAL PLOUGHING CONTEST

TIME SIGNALS FOR PLOUGHING COMPETITIONS

10.30am All Ploughing Competitions Commence

11.00am Stop for Judging of Opening Split

11.40am Restart

2.20pm Ten Minute Warning Signal

2.30pm Final Signal for Finish



'15/16

RULE CHANGES

NATIONAL PLOUGHING CONTEST

Grading

Regulation and Condition No. 12 – See page 12

Rules per Class

No 7 b. In the Standard 3 Furrow Conventional Plough Class a competitor may win this class a maximum of 3 times, then he/she must opt out.

- And – Previous competitors at National Level not eligible for Standard 3 Furrow Conventional.
- Previous Competitors at National Level not eligible for Standard 3 Furrow Reversible.



'15/16

RULES

NATIONAL PLOUGHING CONTEST

1. **Entry:** Submission of an entry will be regarded as an acceptance of all Rules and Regulations and the preparedness of the competitor to observe them or submit to penalties for breaches of same.
 2. **Consultants:** The N.P.A. shall appoint Directors to be known as the Consultants. To whom may be referred any question, or the interpretation of any rule, or order, on the day of the Contest, and the decision of these Directors, or the majority of them, shall be final and binding on all parties. They will also inspect ploughs on days of the Contest.
 3. **Misconduct:** Any Competitor or known Sup-
porter, so misconducting himself or herself at the National, County or Parish Ploughing competitions, meetings or associated activities, as to bring dis-
credit on the Organisation, shall be reported to the Council of the N.P.A. who shall take such action as may be deemed advisable.
 4. **Opening Split:** In both lea and stubble plough-
ing, competitors must make an opening split. The
rippings so turned out must be well cut through
and no land left unturned in the middle of the
ridge. Thirty minutes will be allowed for opening
split when all ploughing must cease for 40 minutes
(judging time). Competitor must have opening com-
pleted and his tractor and plough outside scribe
mark on headland when signal is sounded. **Penalty
for late finish of Opening Split: loss of 5 marks
per minute or part thereof.**

(a) **Ripplings:** Rolling of ripplings with tractor are
not allowed. Penalty for rolling: 10 marks.
 5. **Sighting Poles:** for sighting and setting out, three
poles only may be used inside wire. Anything
additional outside wire constitutes an infringement.
Penalty: 5 marks. Sighting poles must be sighted in
line "V" where plot number is provided by N.P.A.
Penalty: 10 marks.
 6. **Helpers:** A helper will be allowed to erect and
remove sighting poles but not allowed to wrench
or adjust plough on headlands during contest and
must remain outside wire. **Penalty: 10 marks.**

In the Farmerette, Macra and Under 21 a helper
wearing an official armband may remain inside
wire provided he/she does not go inside scribe
mark. He or she can advise, and adjust plough, on
headland only. If helper wishes to
assist on both headlands, he/she must use the
recognised pedestrian route only. Breaches
10 marks first offence, 5 marks each offence
afterwards

In the Farmerette class, helper is also allowed to
erect and remove sighting poles and to measure
first 2 rounds of cast off only and lift plough on
headland, for final (sole) furrow. Opening Split
must be done in this class. Helper must not go on
ploughed ground without permission from Chief
Supervisor. **Penalty: 10 marks.**
 - 7.a **Horse Ploughing Only:** Time allowed 4 hours.
Middle, National Style, Furrow, black sod discon-
tinued. Depth, minimum 6 inches but this does
not apply for first or last three rounds. Horses
must be provided by the competitors. Scribe sods
are optional but in no more than two rounds
and cannot be moved by hands or feet. Brushing
of first two sods allowed but only once. Where
a competitor has a split off 10 minutes will be
allowed. Helper allowed to erect and take down
marking poles. **Depth and Time Penalty will
apply as in all other classes. Last green sod to
crown. Middle 10 sods.**
 - 7.b Total number of people on horse ploughing plot
is maximum of 3; this is to include 1 competitor
and 2 helpers, one of which must remain on the
headland.
- All Competitors must start from same end with highest
number to their right hand side.



'15/16

RULES

NATIONAL PLOUGHING CONTEST

8. TYPE OF PLOUGH:

(a) The type of plough is left to the discretion of the competitor will be a stipulation that the plough shall not be fitted with any extraneous attachments the function of which is to treat or fashion the slice after being turned by the plough. Any extraneous attachment which is applied upon the slice or furrow is regarded as a subsequent tillage tool and is additional to the plough. Only one flat tailpiece to each mouldboard is permitted.

(b) A plough body must not be removed or otherwise adjusted in such a way as to make the plough in effect a single furrow mouldboard. One body may be used opening or finishing, provided both bodies remain in position as a complete two furrow mould board fitted with shares, disc-coulters, skimmers.
Penalty: 10 marks.

(c) There is no restriction on the changing of disc-coulters or shares for the making of the "Opening" or "Finish".

(d) i) Use of GPS, laser beams, cameras, electronic visual aids not allowed.
ii) Use of extraneous attachments to the tractor that manipulate or fashion the furrow not allowed
iii) Only 3 working ploughing wheels on conventional allowed

(e) If using a 3 furrow plough it shall be permissible to raise only one body. If using a 4 furrow plough it shall be permissible to raise only 2 bodies to an out-of-action position when Ploughing the Opening Split only.
Penalty: 20 marks.

(f) Competitors who qualify for Test Match are not obliged to use the same plough on both days.

9. Supervisors: The N.P.A. shall appoint a Chief Supervisor who will brief and allocate positions to Supervisors on days of the Contest.

Supervisors will issue one warning only after which points will be deducted for breach of any rule.

10. Depth of Ploughing:

Depth of ploughing to be measured approx 10cm from furrow wall.

Minimum depth

For all grassland..... 18cms

For all stubble 18cms

For each cm or part of,
less than 18cms 2 marks

If the competitor does not make adjustment after penalty being imposed, he/she is liable for an additional **penalty of 4 marks.**

Measuring team appointed by N.P.A. In all Classes reduction in depth allowed during last three rounds

11. Middle: In lea and all 2 furrow stubble classes, a middle shall consist of 15/16 sods. The remainder of plot shall be split to the higher number. Depth measurements must not be taken until a competitor has completed 3 rounds (12) sods and must not be taken on last three rounds of furrow.

Penalty: 10 marks.

In the 3/4 Stubble Classes a middle shall consist of 17/18 sods. **Penalty: 10 marks.**

12. Extra Time: Extra time may be requested only in case of a mechanical breakdown or a situation beyond the control of the competitor or the organisers. In the case if waiting on his neighbour the competitor must contact his Supervisor and through him receive a decision from the Consultants.

Competitors who have drawn end plots will not be allowed extra time for measuring off, but must do so during the 40 minutes break while the opening splits are being judged. Helper allowed to erect and take down marking poles.

Farmerettes who have drawn end plots to measure off before contest starts or during the four hours allowed. Helper to erect and take down marking poles.



'15/16

RULES

NATIONAL PLOUGHING CONTEST

13. (a) **Straightening:** Only 2 rounds allowed on "Cast-Off" side, 3 markers allowed at discretion of competitor for each round for this purpose only. If more than 3 markers. **Penalty: 5 marks.**
- (b) A competitor may plough one round and drive on his/her own ploughing plot. Must not damage neighbours plot. **Penalty: 5 marks.**
14. **Measuring:** Where a competitor does not plough a full plot. **Penalty: 10 marks.**
15. **Furrow:**
- (a) The final furrow will be black-sod or sole furrow. Only one wheel mark allowed in the furrow and this must be on the cast off side. Plough wheel mark must be within tractor wheel mark. **Any other wheel mark on the plot is a fault and will be judged accordingly by the judges.**
- (b) The light sod at cast-off side of final furrow should be visible from end to end. There should be no wheel mark on this sod except in the 3/4 furrow classes at the discretion of competitor. In all classes, **Penalty for faulty wheel mark: will be judged accordingly by the judges.**
- (c) The black sod must be turned towards the crown or middle. **Penalty: 20 marks.**
- (d) **Finish:** A 10 minute warning signal will be given before finishing time. When the Final Signal is sounded, a competitor must have his plot fully completed and his Tractor and Plough outside scribe mark on headland. If NOT finished he/she will lose 5 marks for every minute or part of a minute he/she is late.
- (e) Competitors after entering the furrow are only allowed to come back to adjust plough. No walking on furrow permitted when plot is completed. **Penalty: 10 marks.** This rule does not apply to Under-21 and Farmerette Classes.
16. **Penalties:**
- (a) Practising on any part of Ploughing championship site – **Penalty 10 marks.**
- (b) Rolling of Ins and Outs – **Penalty 10 marks.**
- (c) Competitors must enter front plough on the scribe mark, Ploughing outside scribe mark. **Penalty 5 marks.**
- (d) 10 marks for removing plough.
- (e) Practising on or damaging a Championship Plot – **disqualification.**
- (f) Getting down off tractor on ploughed ground – where a two door tractor is in use – **Penalty 5 marks.**
- (g) Footing, handling, walking on ploughing or use of fork or spade or any other implement on ploughed ground, or getting off tractor on ploughed ground. **Penalty 5 marks for each offence.**
- (h) A competitor may lose maximum of 50 marks for breaches of rules, plus 5 marks for every minute or part there of if late finishing furrow.
17. **Switching of Ploughs:** Not allowed unless permission has been obtained from the Consultants or Supervisors.
18. **Weights:** Weights will be allowed on all types of ploughs in all classes.



'15/16

RULES

NATIONAL PLOUGHING CONTEST

19. If a competitor walks across any plot before judging is finished, he/she will be liable for a penalty of 10 marks without any warning. The supervisor has authority to apply this penalty and in his absence the Judge or NPA Director has authority.
20. **Standard 3 Furrow and Standard Reversible Class:**
In these classes ploughs will be inspected before and during the competition.
- No age limit.
 - Hydraulics allowed on plough.
 - Hydraulic top Link allowed.
 - Wheel allowed. Open split and ins and outs must be done.
 - Vari-widths allowed.
 - No extra tail piece.
 - No special shares.
 - No modifications.
 - For the purpose of Standard 3 Furrow and Standard Reversible Classes Number 25 body not allowed.
- Penalty: 10 marks.**
21. Penalty of 25 marks will be imposed on competitors who park or drive their vehicles on any part of the competition grounds. There will be an assembly yard provided for all equipment.
22. Competitor allowed to remove loose material but pulling or raking stubble not allowed. Penalty: 10 marks.
23. Competitors or persons acting on their behalf, known to be working on their plot prior to the competition will be eliminated from the competition.
24. **Judges:** County and parish levels, one judge in every three can be from the County.
25. Competitors who do not qualify from their County competitions cannot take part in the All-Ireland Ploughing Championships.
26. All competitors must start Ploughing from the same end with highest number to right hand side.
27. **FINAL DECISION**
Any question arising and not provided for in these rules will be decided by the governing Board of the National Ploughing Association whose decision shall be final and binding. The NPA reserve the right to take whatever action deemed necessary for breach of any rules or regulations.
28. **Objections:**
An objection must be lodged in writing to the Secretary of the NPA accompanied by the fee of €10 not later than one hour after the results have been announced. The competitor or one person nominated by the County concerned may request a meeting with the Consultants to support his/her objection and the National Ploughing Executive Committee will make the final decision within 28 days.



‘15/16



REVERSIBLE PLOUGHING RULES

ALL OTHER RULES APPLY WHERE APPLICABLE

1. Sighting and Setting Out

a) Three sighting poles only may be used. One pole may be sighted on the headland of the plot.

Penalty 5 marks.

b) The use of plot number markers, guide lines, foot-marks, stones or any guide other than the three sighting poles is not allowed.

Penalty 5 marks.

c) Competitors may have assistance to place and remove the sighting poles. No other assistance allowed during the contest. **Penalty 10 marks.**

2. OPENING FURROW

a) In reversible Ploughing competitors must make a single opening furrow at the setting out.

b) The opening furrow is a single furrow ploughed from the start using the rear right-body.

c) Time allowed for the completion of the opening furrow – 30 minutes.

d) Failure to complete the opening furrow in the permitted time will be penalized. **Penalty loss of 5 marks per minute or part thereof.**

3. METHOD OF PLOUGHING

a) Scratch mark for butts – this scratch mark must be made whilst the opening furrow is being judged. The scratch mark for the butts should be made parallel to the opening furrow to allow 19 or 20 furrows for two furrow ploughs or 20 or 21 furrows for three furrow ploughs from the opening furrow to the butts. Three sighting poles may be used for making the scratch mark. Assistance is allowed to place and remove the sighting poles. No handling or rolling of the scratch allowed.

Either left or right hand bodies may be used for making the scratch mark.

b) Two furrow ploughs – Ploughing must commence using the left hand bodies and after completing eight furrows which shall constitute the Crown, the competitor then proceeds to plough against the neighbour with the next plot number.

c) Three furrow ploughs – Ploughing must commence using the left hand bodies and after completing nine furrows which shall constitute the Crown, the competitor then proceeds to plough against the neighbour with the next higher plot number. **Penalty 10 marks.**

d) On completion of the Crown the competitor then ploughs all the land between the next competitors plot and his scratch mark, thus completing the butts.

e) e1) Competitors must use all plough bodies when Ploughing the finishing furrows. It is allowed to use only one plough body when Ploughing the connecting furrow.

e2) Two furrow ploughs – the finishing furrows shall be the remaining 19 or 20 furrows between the butts and the finishing furrow, including the connecting furrow. All competitors must make 10 runs to conclude the finishing furrows. The connecting furrow may be ploughed showing one or two furrows but with all bodies in a working position. No further single furrows across the whole field are permitted. **Penalty 5 marks.**



'15/16

REVERSIBLE PLOUGHING RULES

- e3) Three furrow ploughs – the finishing furrows shall be the remaining 20 or 21 furrows between the butts and the finishing furrow, including the connecting furrow. All competitors must make 7 runs to conclude the finishing furrows. The connecting furrow may be ploughed showing two or three furrows but with all bodies in a working position. No further single furrow (two bodies in work) across the whole field are permitted. Penalty 5 marks.
- f) Attachments are not allowed when Ploughing the connecting furrow. **Penalty 5 marks.**
- g) The competitor then starts at the scratch mark for the butts and ploughs to a finish at the cut of the opening furrow. Sighting poles or any other guide are not allowed when ploughing the connecting furrow at the scratch mark for the butts. **Penalty 5 marks.**
- h) The final furrow should be cut close to the opening furrow. There should be no land left unploughed and no part of the first furrow of the start re-ploughed. The first furrow and the final furrow should be the same height.
- i) Only one tractor wheel mark allowed at the finish. Plough wheel mark must be within tractor wheel mark. **Any other wheel mark on the plot is a fault and will be judged accordingly by the judges.**
- j) Alternative bodies must be used at all times when Ploughing plot.
- k) Idle runs are not permitted.
Penalty – 10 marks per run.
4. **FINAL DECISION**
Any question arising and not provided for in these rules will be decided by the Governing Board of the National Ploughing Association whose decision shall be final and binding.

EXPLANATORY NOTES ON THE REVERSIBLE PLOUGHING RULES

THE OPENING FURROW – Reversible Ploughing: The depth of the scratch should be such that the furrow slice is cut completely free from the under-soil surface throughout the whole length of the opening furrow. The scratch should be straight, neat and uniform in its' whole length.

THE CROWN/START – Reversible Ploughing: All land must be cut through. The first furrow of the crown should be turned into the opening furrow and the cut edge of the furrow should be level with the cut edge of the opening. The furrows in the crown should conform with the rest of the ploughing.

WEED CONTROL:

- A All stubble and grass must be completely buried beneath the furrows.
- B The ploughing should be done in such a way that all roots are cut or torn off.
- C Skimmers must be used.

SEED BED:

Furrows should be properly turned so that sufficient soil is made available to produce a seed bed without pulling stubble or grass to the surface in the future cultivations.

THE FINISH – Reversible Ploughing:

The final furrows adjoining the crown/start should be of equal height to the crown and there should be no unploughed or reploughed land.

INS AND OUTS:

The front share should enter the ground at the headland scratch mark and the rear share should leave the ground at the headland scratch mark.

GENERAL APPEARANCE:

- A All furrows in the plot should be straight, clearly defined, uniform and well turned with good weed control.
- B Faulty ploughing done by the neighbouring competitor should be corrected in the first and second runs adjoining the neighbours plot. The tractor must not be driven on the ploughed land.



'15/16

MARKING FOR REVERSIBLE PLOTS

1. When setting out the plots the first plot must be squared and then offset to ensure that all plots are the same (See fig 1)

Fig 1

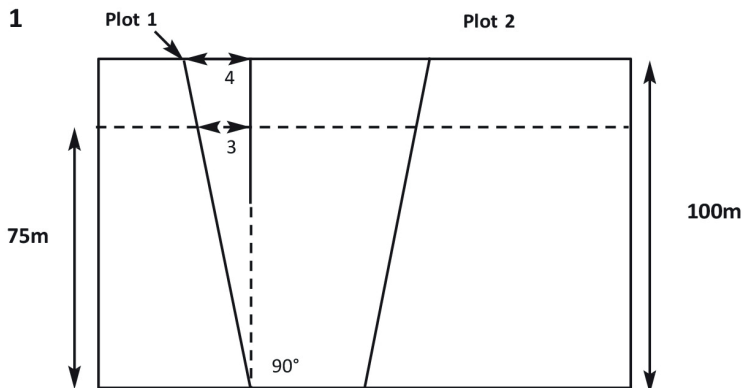

2. If plots are shorter than 100 meters the angle for butts must be maintained.

Example.

- a) If plot is 100m long, there must be an 8m difference between one headland and the other.
- b) If a plot is 75m long, there must be a 6m difference between one headland and the other.
- c) If a plot is 50m long, there must be a 4m difference between one headland and the other. (See fig 2)

Fig 2

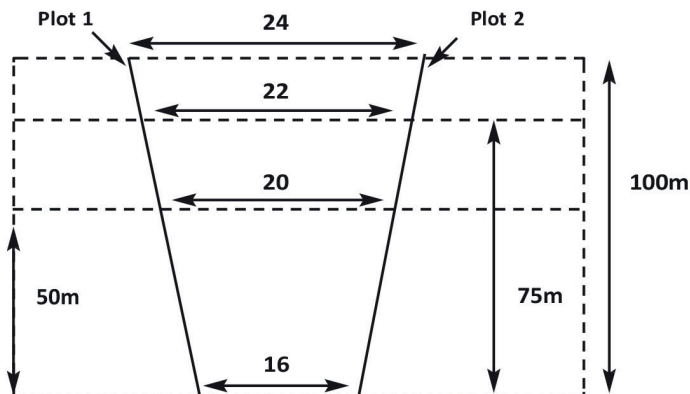



'15/16



LAYOUT OF PLOT REVERSIBLE PLOUGHS

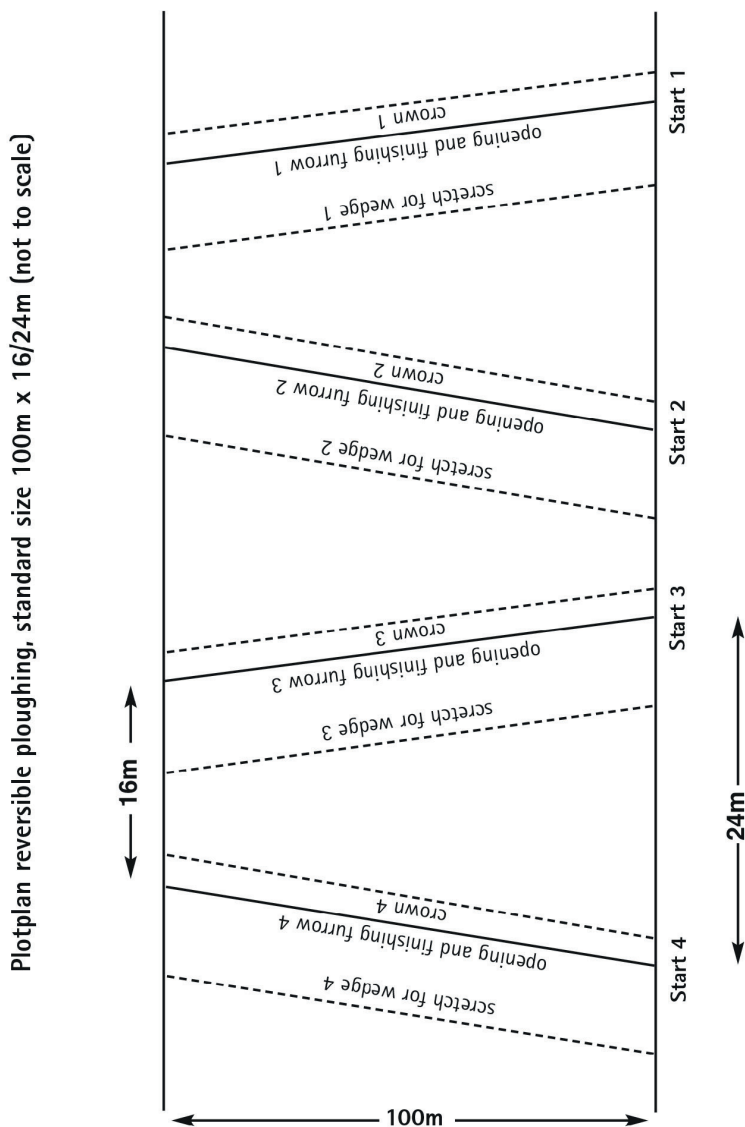



'15/16

SKETCH OF APPROVED TAILPIECE

Maximum Length and Width

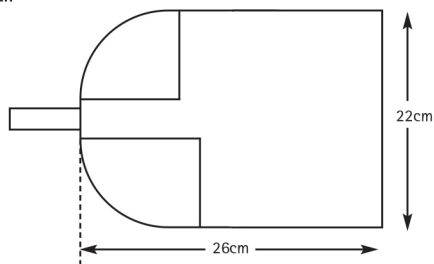

Ratio of Concave or Convex = 1-15

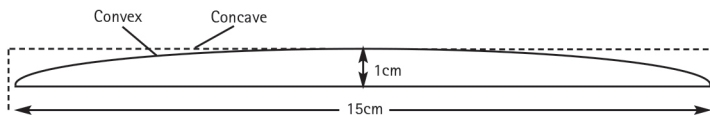

Maximum Overall Length from Mouldboard

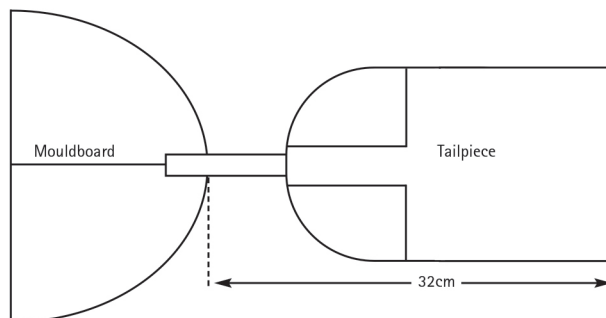



REGULATIONS & CONDITIONS NATIONAL PLOUGHING CONTEST

'15/16

- 1.a Membership of the N.P.A. Ltd., As shall be prescribed from time to time by Articles of Association of N.P.A. Ltd.
- 1.b A person is only permitted to be a member of one ploughing club. He/She may however be a member of a club and a county association.
2. Venue: The venue of the National Ploughing Championships shall be selected by the Directors of the N.P.A. Ltd.
3. The Directors of the N.P.A. reserve the right to alter, amend, delete or add to the Rules at their discretion at any time, except during the four weeks preceeding or during the Championships.
4. Resident: A competitor shall be a born native of the county for which he or she competes or shall be working resident in the county for not less than 3 months prior to the date of the contest.
5. Age: No competitor under the age of 16 is permitted to plough in a match or be present on the plot run under NPA rules. Competitors taking part in tractor ploughing must have a driving licence.
6. Identification: Competitors must display identification placards which are provided and return them to Marshalling Yard.
7. Judges: The Directors of the N.P.A. shall select the Judges.
- 8.a Draw for Plots: Drawing for plots shall be conducted each year by the Managing Director of N.P.A.
- 8.b At National Championships – no competitor is permitted to change plot unless a decision is made to do so by the NPA consultants.
9. Cups and Trophies: Will be presented to the winners at Competitor's Banquet on Sunday 11th October 2015, Heritage Hotel Portlaois, Co. Laois. Cash Prizes will be sent by post one month after the Championships.
10. Bonds: The custody of any Perpetual Cup or Trophy may be given to a successful competitor (or his representative) who shall provide such security as may be demanded for the return of such Cup or Trophy in good condition, or its value when requested by the National Ploughing Association.
11. Method of Judging: The Judge shall assess the quality of the ploughing in accordance with the method of scoring as decided upon and required by the N.P.A.
12. Grading: – Individual.
Based on individual merit and performance.
 - (a) In the Senior Conventional Plough Class, the last two placed competitors will be graded Intermediate in 2016.
 - (b) In the Intermediate Conventional Plough Class the top two placed competitors will go up Senior in 2016 and the last two placed competitors will go Junior in 2016.
 - (c) In the Junior Conventional Plough Class the top two placed competitors will go up Intermediate in 2016.
 - (d) In the Senior Reversible Plough Class the last two placed competitors will be graded Intermediate in 2016.
 - (e) In the intermediate Reversible Plough Class the top two placed competitors will be graded Senior in 2016.
 - (f) UNDER 28 CONVENTIONAL SENIOR & JUNIOR, UNDER 21 CONVENTIONAL SENIOR & JUNIOR & UNDER 28 REVERSIBLE CLASSES For competition year 2015/2016 & NPC 2016 underage classes will be graded by old system i.e. by grade of County. Under 28 Conv – top placed County in Junior will be graded Senior, and the last placed County in Senior will be graded Junior. Under 21 Conv – top placed County in Junior will be graded Senior, and the last placed County in Senior will be graded Junior.
 - (g) Grading when a competitor is no longer eligible to plough U-28 Conventional



REGULATIONS & CONDITIONS NATIONAL PLOUGHING CONTEST

- Under 28 Conv. – Senior grade – when no longer eligible will be graded Intermediate Conventional
- Under 28 Conv. – Junior grade – when no longer eligible will be graded Junior Conventional

(h) Grading when a competitor is no longer eligible to plough U-28 Reversible:

- Will be graded Intermediate Reversible.

(i) All other competitors who competed at the 2015 All Ireland are graded at the grade they ploughed in.

(j) If a new competitor qualifies from a county and has not ploughed at All Ireland level before he/she will enter at junior grade.

(k) If a competitor does not qualify 1st, 2nd or 3rd in the county qualifying matches 2015/16 then he/she is not eligible to plough in NPC 2016.

(l) If a competitor does not plough for a number of years and returns to plough his/her grade will be what he/she was last graded.

13.(a) Selection of Competitors For National Event:

Counties will have the right to arrange their own classes. Competitors securing highest marks in the County shall be selected to represent their county.

(b) At County/Club level a competitor must declare what class he/she is competing in before competition season starts. Competitor can only declare one class for the entire ploughing season.

(c) In order to qualify for National Ploughing Championships competitors must compete in a minimum two matches. This applies to ALL classes.

14.a) NATIONAL SENIOR CONVENTIONAL CHAMPION:

All Senior Competitors plough on Wednesday as well as the top two placed competitors from Republic of Ireland in the U28 Conventional Plough Class and the top two from the Republic of Ireland in the Intermediate Conventional Plough Class. The top ten placed competitors (From Republic of Ireland not including non ROI competitors) on Wednesday will plough in the Senior Conventional Test Match on Thursday.

The competitor with the highest combined marks from the Senior Conventional Class on Wednesday

and the Senior Conventional Test Match on Thursday will be the NATIONAL SENIOR CONVENTIONAL CHAMPION.

The competitor with the highest combined marks from the Senior Convention Class on Wednesday & the Senior Conventional Test Match on Thursday (from Republic of Ireland) will qualify for the World Contest 2016 in England.

The runner-up of the Senior Conventional Test Match will qualify will go to the 2016 Five Nations.

The 3rd and 4th placed competitor in the Senior Conventional Test Match will go to Northern Ireland competition.

b) Where the county has no Under-28 Competitor the Under-21 competitor is allowed to compete in the Under-28 and to revert back to Under-21 if he/she so wishes.

c) For both the Senior Conventional Test Match and the Kvernland Reversible Test Match on Thursday. In the event of the top two placed competitors in the U28 and in the Intermediate do not wish to go forward to the Test Match. Option is not open for 3rd place competitor.

d) Tractors parked just outside ploughing is unacceptable. All tractors should be parked back at rope/twine when Ploughing is finished.

15. Scale of Marks for U-21, 3 Furrow, Macra, Farmerette, Junior and for Conventional – Senior, Intermediate, Under 28 and Supreme Senior Tractor Championship:

OPENING SPLIT

- Neatness – Cut Through
- Uniformity of Furrows10 marks
- Straightness10 marks

MIDDLE

- Uniformity of Furrows10 marks
- Weed Control10 marks
- Straightness10 marks

GENERAL WORK

- Skimming.....10 marks
- Packing and Firmness.....10 marks
- Soil make available (Flesh)10 marks
- Uniformity10 marks
- Straightness10 marks

FURROW

- Uniformity of Furrows10 marks
- Weed Control10 marks
- Straightness10 marks

INS AND OUTS.....10 marks



REGULATIONS & CONDITIONS NATIONAL PLOUGHING CONTEST

GENERAL APPEARANCE

All aspects and workmanship clearly

defined and uniform furrows.....10 marks

GROSS TOTAL150 marks

Marks for Horse Class:

Middle.....50 marks

Skim.....20 marks

Pack.....20 marks

Flesh20 marks

Straightness and Appearance20 marks

Ins and Outs.....10 marks

Furrow.....50 marks

Marks for Vintage:

Opening Split10 marks

Ins and Outs.....10 marks

Middle40 marks

Skim25 marks

Pack25 marks

Flesh25 marks

Appearance Et Straightness25 marks

Furrow.....40 marks

GROSS TOTAL200 marks

16. In the event of a tie in conventional classes the matter will be deferred to the Scrutineers and competitors gaining highest combined marks for middles and furrows will be placed in order of merit, but in classes where straightness of middles and furrows have been judged, these points will be taken into account.

17. Religious beliefs be adhered to and if Sunday Ploughing is not acceptable to all denominations, it should not be held. If this rule is violated, no competitors will be accepted from that county at the National Championship.

18. Reversible Classes: Three grades: Under-28 on the 1st January of competition year. Senior and Intermediate Reversible open to any age.

A National Senior Reversible Champion:

All Senior competitors plough on Wednesday as well as the top two placed competitors from the Republic of Ireland in the U28 Reversible Plough Class and the top two from the

Republic of Ireland in the Intermediate Reversible Plough Class. The top ten placed competitors (From Republic of Ireland not including non ROI competitors) on Wednesday will plough in the Kverneland Reversible Test match on Thursday.

The competitor with the highest combined marks from the Senior Reversible Class on Wednesday and the Kverneland Reversible Test Match on Thursday will be the National Senior Reversible Champion.

The competitor with the highest combined marks from the Senior Reversible Class on Wednesday and the Kverneland Reversible Test Match on Thursday (from Republic of Ireland) will qualify for the World Contest 2016 in England.

The runner-up of the Kverneland Reversible Test Match will go to the 2016 European Reversible.

The 3rd placed competitor in the Kverneland Reversible Test Match will go to the 2016 European Reversible.

The 4th placed competitor in the Kverneland Reversible Test Match will go to the 2016 Five Nations.

The 5th placed competitor will qualify for the Northern Ireland Competition.

B In the event of a tie, the marks for the Crown and Straightness of Crown, and the marks for the finishing Furrow and Straightness of finishing Furrow be totalled. If still a tie plough-off to be arranged.

C Under-28 Reversible competitor can compete in Senior Reversible and then revert back to Under-28 Reversible Class.

D Pressers at same angle as Mouldboard. Diagram as for reversible.



'15/16

VINTAGE PLOUGHING RULES 2015

As drawn up by the Vintage Ploughing Association, in association with NPA.

1. Competitors in All-Ireland Competitions must be paid up members of the vintage Ploughing Association of Ireland.
2. Competitors must qualify from their own County. Minimum of one score sheet from own County must be used. Four official Irish score sheets must be submitted for selection purposes. Executive committee have power to overrule on this if extra plots are available and competitor may have less than 4 sheets through no fault of his own.
3. Ploughs must be to original specification; boards must not exceed 45" (1145mm) from the tip of the point to the rear of the board or be not more than 11 1/2" (292mm) high (if not penalty marks will be imposed).
4. Tail knives are allowed cutting at right angles to the sod, (max length 5" (127mm) behind the board). Pressers or extensions to boards not allowed.
5. Sliding or adjustable drawbar on tractor is allowed (trailer class).
6. Tractors and Ploughs will be inspected before and during the competition and any extraneous equipment or devices not regarded as original will incur penalty points.
7. Points may be fabricated if no supplier is available but must remain as close to the original as possible in length and width.
8. 30 minutes to be allowed in the event of a breakdown, or a replacement vintage tractor may be used, but the plough cannot be changed.
9. Tractors must be pre-1959, be TVO or petrol or single cylinder diesel and must be presented in rally condition, diesel tractors in manufacture up to 31st December 1958 will qualify as a result of vote taken at A.G.M. May 2010 by majority of members present.
10. Depth: Minimum depth for two furrow 6 inches, single furrow 5 inches.
11. Opening split is compulsory in stubble only in the Two Furrow Mounted and Two Furrow Trailer Classes only. In the Single Furrow Class no scribe or scribing is allowed.
12. Adjustable or snap top links are allowed in the Vintage Two Furrow Mounted Class. Hydraulic top links not allowed.
13. In the Single Furrow Class, brushing of the two front sods is optional and only allowed in one round.
14. Reversible or larger disc coulters can be used.
15. Tractors must be insured. The driver must be over 16 years and have a current drivers licence and must be insured to drive the tractor at Ploughing Matches.
16. The Single Furrow Class is now confined to a Farmhall Cub Size class, i.e. the tractor must be under 16HP and the plough must be original not a cut down plough.
17. Land wheels must be no wider than 4" (102mm) and cannot have a marking disc fitted, movement of the Land wheel towards and away from the plough is allowed.
18. Hillside levers or adjusters across the lower link arms are not allowed. Stabiliser Bars and stabiliser chains are allowed.
19. Only one set of skimmers will be permitted for use on any plough. Skimmer blades must be original or from the same era. Holders can be changed.



'15/16

VINTAGE PLOUGHING RULES 2015

As drawn up by the Vintage Ploughing Association, in association with NPA.

20. A maximum of 3 idle runs allowed only in all Classes.
21. Double wheels or dual wheels on tractors not allowed.
22. Differential lock on Ferguson 35 not allowed.
23. All competitors will start with the higher plot number on their right hand side.
24. The plough land wheel must follow within the left-hand rear wheeltrack on the last run when ploughing the sole sod. (2F Mounted).
25. Match ploughs or match plough bodies not allowed i.e. Ransome TCN UCN or SCN (eg. Ransome TS86).
26. A competitor may not drive on the two outer sods of the split out at anytime even after it has been judged (you cannot role the rippings) the chip may be put in the centre but the r/h front wheel must be in the furrow when doing so.

Only if the above rules are complied with, will a person be allowed to compete. The Vintage Ploughing Association will not accept any responsibility whatsoever regarding insurance claims.

Competitors will be penalised min 5 penalty marks for each infringement of any rule.

**NOTE: FOR ALL COMPETITORS
TRACTORS & PLOUGHS TO BE PARKED IN
ASSEMBLY AREA ONLY**



LOY ASSOCIATION OF IRELAND

CUMANN LAI NA HEIREANN

RULES & PROCEDURES

RULES

1. The Loy should be in keeping with traditional shapes or designs. No adjustment of any kind allowed (Penalty – 20 marks).
2. Competitors are allowed to erect lines and pegs (3 lines & 6 pegs) on the plot before the starting signal, but must remove them before digging commences (Penalty 10 marks).
3. Competitors must stop digging when final whistle is blown. The supervisor will put down a red peg where the last sod has been turned. The competitor can then finish the plot. When finished, the competitor must leave the plot area altogether. (Penalty – 10 marks for unfinished plot plus 1 mark per ft from red peg)
4. If a competitor walks across his own or any other plot before judging is finished, he/she will be liable for a penalty of 10 marks without warning.
5. Dressing allowed only with the loy from digging position. Touching or fixing the sod by hand or foot is not permitted (Penalty – 10 marks without warning)

PROCEDURES

1. Competitors competing in national and local competitions must be paid up members of their county ploughing association.
2. Competitors in All-Ireland Competitions must be paid up members of Loy Association Ireland.
3. Competitors must qualify from their own county.
4. Submission of an entry will be regarded as an acceptance of all rules and regulations and the preparedness of a competitor to observe them or submit to penalties for breaches of same.
5. To commence a competitor must set up 3 lines with 6 pegs 46" apart. The plot consisting of 2 ridges should be 92" wide. The plot is now ready for nicking and will be inspected by the supervisor.
6. When the signal is sounded, nicking commences. All 3 lines should be nicked and lines lifted before digging commences.
7. On a base of a 3ft 10", a ridge will consist of 2 sods, turned towards each other leaving a verge in the centre. Each sod should be 10.5" wide and a centre verge 4" wide. Recommended depth of furrow 3-4".

8. Time allowed: 3 hours.

9. Ridge Length

Senior & junior	30ft
Under 25	30ft
Under 21	15ft
Ladies	10ft

The committee have the discretion to shorten plots at All-Ireland with regards to hard ground 2013 AGM.

10. A second loy may be used in the event of a breakage and extra time maybe given to a competitor with permission being obtained from a supervisor.
11. Age threshold for under age class. Competitors in the U25 class must be under 25 years of age on the 1st January of the competition year. Competitors in the U21 class must be under 21 years of age on the 1st January of the competition year. A competitor who falls under the u 21 category cannot compete/win in the U25 class category. i.e. if under 21 the competitor competes in that grade. If over 21 he/she competes in the under 25 grade. Proof of age must be produce either with driving licence or birth certificate when entering.

12. In the senior class, the lowest marked competitor will be re-graded to junior class and the junior winner will go up to senior.

MARKS

2 Half Furrows.....	25 marks
Matching Centre Verge	40 marks
Pack & Flesh.....	25 marks
Main Furrow.	30 marks
Ends.....	15 marks
Appearance & Straightness.....	15 marks
Total.	150 marks

Note

Supervisors will be on site one hour before Digging commences to check competitors etc etc and will stay until Judges are finished. Supervisors and Judges must check into tent before 9am on morning of competition. Supervisors must wear white coats provided by the NPA during the competitions.



'15/16

PROGRAMME OF PLOUGHING CLASSES 2015

Tuesday 22nd September

- 3 Furrow Conventional Match Plough Class
- Standard 3 Furrow Conventional Plough Class
- Under 28 Conventional Plough Class
- Under 28 Reversible Plough Class
- Intermediate Conventional Plough Class
- Intermediate Reversible Plough Class
- Vintage 2 Furrow Trailer Plough Class
- Under 40 Horse Plough Class

Wednesday 23rd September

- Senior Conventional Plough Class (Day 1)
- Senior Reversible Plough Class (Day 1)
- Farmerette Conventional Plough Class
- Macra 2 Furrow Conventional Plough Class
- Vintage 2 Furrow Mounted Plough Class
- Visitors 2 Furrow Conventional Plough Class (Day 1)
- Senior Horse Plough Class

Thursday 24th September

- Senior Conventional Test Match (Day 2)
- Kverneland Reversible Test Match (Day 2)
- Junior Conventional Plough Class
- Standard 3 Furrow Reversible Plough Class
- Under 21 Conventional Plough Class
- Vintage Single Furrow Mounted Plough Class
- Special Horse Plough Class
- Visitors 2 Furrow Conventional Plough Class (Day 2)
- Loy Digging



'15/16

RULES PER PLOUGHING CLASSES 2015

1. ONE COMPETITOR / ONE CLASS

One Competitor / one class.

Exemption to this is as follows;

- a) Senior Conventional & Senior Reversible classes
- b) Qualifications from the Under 28 conventional / reversible, Intermediate conventional / reversible to the senior class on Wednesday.
- c) Qualifications from the senior convention / reversible to test match on Thursday.
- d) Also Horse classes.
- e) Visitors classes.

2. SENIOR CONVENTIONAL

(Senior, Intermediate, Junior Grade)

- a) Individual ploughman/woman is graded according to where they plough in 2015 or according to if they are subject to regrading from 2015 NPC results.
- b) 3 competitors per County permitted over the 3 classes- Junior, Intermediate & Senior. 4 competitors (at least) must plough in Senior Classes at County level if a 3rd competitor is to qualify.
- c) If a competitor does not qualify 1st, 2nd or 3rd in the county qualifying matches 2015/2016 then he/ she not eligible to plough in NPC 2016.
- d) If a competitor returns to plough after number of year's absence he/she will plough at their last grade.
- e) If a competitor is a newcomer he/she will enter at junior grade.
- f) Competitors qualifying for All Ireland Ploughing Championships must have competed in a minimum of two matches.
- g) The top two placed competitors in the Intermediate Conventional Class (from the Republic of Ireland)

and the top two placed competitors in the Under 28 Conventional Class-Senior Grade (from the Republic of Ireland not including non ROI competitors) will qualify for the Senior Conventional Class on Wednesday.

- h) The top ten placed competitors (from the Republic of Ireland not including non ROI competitors) in the Senior Conventional Class on Wednesday will qualify for the Senior Conventional Test Match on Thursday.
- i) The National Senior Conventional Champion will be the competitor with the highest combined marks from Senior Conventional Class on Wednesday & the Senior Conventional Test Match on Thursday.
- j) The highest placed competitor (from Rep. of Ireland) over the two days will qualify for the World Contest 2016 in England.
- k) No age limit in this class.

3. SENIOR REVERSIBLE

(Senior, Intermediate Grade)

- a) Individual ploughman/woman is graded according to where they plough in 2015 or according to if they are subject to regrading from 2015 NPC results.
- b) 3 competitors per County permitted over the 2 classes- Intermediate & Senior. 4 competitors (at least) must plough in Senior Classes at County level if a 3rd competitor is to qualify.
- c) If a competitor does not qualify 1st, 2nd or 3rd in the county qualifying matches 2015/2016 then he/she not eligible to plough in NPC 2016.
- d) If a competitor returns to plough after number of year's absence he/she will plough at their last grade.
- e) If a competitor is a newcomer he/she will enter at intermediate grade.



'15/16

RULES PER PLOUGHING CLASSES 2015

- f) Competitors qualifying for All Ireland Ploughing Championships must have competed in a minimum of two matches.
 - g) The top two placed competitors in the Intermediate Reversible Class (from the Republic of Ireland) and the top two placed competitors in the U-28 Reversible Class (from the Republic of Ireland) will qualify for the Senior Reversible Class on Wednesday.
 - h) The top ten placed competitors (from the Republic of Ireland not including non ROI competitors) in the Senior Reversible Class on Wednesday will qualify for the Kverneland Reversible Test Match on Thursday.
 - i) The National Senior Reversible Champion will be the competitor with the highest combined marks from Senior Reversible Class on Wednesday and the Kverneland Reversible Test Match on Thursday.
 - j) The highest placed competitor (from Rep. of Ireland) over the two days will qualify for the World Contest 2015.
 - k) There is no age limit in this class.
 - l) This competition is restricted to 2/3 furrow ploughs.
- 4. UNDER 28 REVERSIBLE**
- a) County may enter only one competitor in this class.
 - b) Competitors in this class must be under 28 years of age on the 1st January of the competition year.
 - c) Competitors qualifying for All Ireland Ploughing Championships must have competed in a minimum of two matches.
 - d) The top two placed competitors in the U-28 Reversible Class (from the Republic of Ireland) will qualify for the Senior Reversible Class on Wednesday.
- 5. UNDER 28 CONVENTIONAL**
- a) County may enter only one competitor in this class.
 - b) Competitors in this class must be over 21 years of age and under 28 years of age on the 1st January of the competition year. Exception: Where a County has two U21 and no U28 competitor – one can enter this class.
 - c) Competitors qualifying for All Ireland Ploughing Championships must have competed in a minimum of two matches.
 - d) The top two placed competitors in the Under 28 Conventional Class-Senior Grade (from the Republic of Ireland) will qualify for the Senior Conventional Class on Wednesday.
 - e) This class is confined to competitors who have not yet won an All-Ireland title in Senior, Intermediate or Junior 2 Furrow Tractor Class.
- 6. UNDER 21 CONVENTIONAL**
- a) County may enter only one competitor in this class.
 - b) Competitors in this class must be under 21 years of age on the 1st January of the competition year.
 - c) Competitors qualifying for All Ireland Ploughing Championships must have competed in a minimum of two matches.
 - d) This class is confined to competitors who have not yet won an All-Ireland title in Senior, Intermediate or Junior 2 Furrow Tractor Class.
- 7. 3 FURROW CONVENTION MATCH / STANDARD 3 FURROW CONVENTIONAL**
- a) In the 3 Furrow Conventional Match and the Standard 3 Furrow Conventional a County may enter one competitor in one of the classes only.



‘15/16

RULES PER PLOUGHING CLASSES 2015

- b) In the Standard 3 Furrow Conventional Plough Class, a competitor may win this class a maximum of 3 times, then he/she must opt out.
- c) Previous competitors at National levels not eligible for Standard 3 Furrow Conventional.
- d) Competitors qualifying for All Ireland Ploughing Championships must have competed in a minimum of two matches.
- 8. STANDARD 3 FURROW REVERSIBLE**
- a) County may enter only one competitor in this class.
- b) This competition is restricted to standard 3 furrow reversible ploughs.
- c) Previous competitors at National levels not eligible for Standard 3 Furrow Reversible.
- d) A competitor may win this class a maximum of 3 times, then he / she must opt out.
- e) Competitors qualifying for All Ireland Ploughing Championships must have competed in a minimum of two matches.
- 9. MACRA**
- a) County / Region may enter only one competitor in this class.
- b) Competitor has the option of using a match or standard plough.
- c) Competitor can not have previously represented their County at National Level.
- d) Competitor can enter this competition as many times as they wish, but once they win the National Macra Class twice, they are no longer eligible to take part in this class.
- e) Competitors qualifying for All Ireland Ploughing Championships must have competed in a minimum of two matches.
- 10. FARMERETTE**
- a) County may enter only one competitor in this class.
- b) Competitors qualifying for All Ireland Ploughing Championships must have competed in a minimum of two matches.
- 11. VINTAGE**
- a) County may enter only one competitor per Vintage Class (3 classes).
- 12. UNDER 40 HORSE, SENIOR HORSE, SPECIAL HORSE CLASSES**
- a) Competitors in the UNDER 40 CLASS must be under 40 on the 1st of January of the competition year.
- b) In the Senior Horse Class, 1st, 2nd, 3rd, 4th placed competitors are not eligible to compete in the Special Horse Class on Thursday.
- c) A County can enter 2 Horse competitors for each class.
- d) Competitors qualifying for All Ireland Ploughing Championships must have competed in a minimum of two matches.
- 13. VISITORS**
- a) Two competitors from Northern Ireland will be accepted in the Senior Conventional Class and one competitor from Northern Ireland into The Senior Reversible Class.
- b) Competitors taking part in another class can carry their marks from that class to the Visitors Class.



Notes





Notes

